

9
8
+99⁵ 0
7
6
5
+200⁶ 0
4
3
2
1
0 0
20 0
19
18
17 0 16° 00'
16
15

2° 30' N 55° 37' E N 35 1/2° E

N 33 1/2° E

N 50° 09' N 51° 07' E N 36° E

N 38° E N 13 1/2° N

(Sta 39+17^{00'}) 34⁺ ft + wash on WE
 Member of water canal from mt #34
 Saturday PM, May 3rd 1890

S 18° 58' N S 81 1/4° W

S 41° 57' N S 24° W

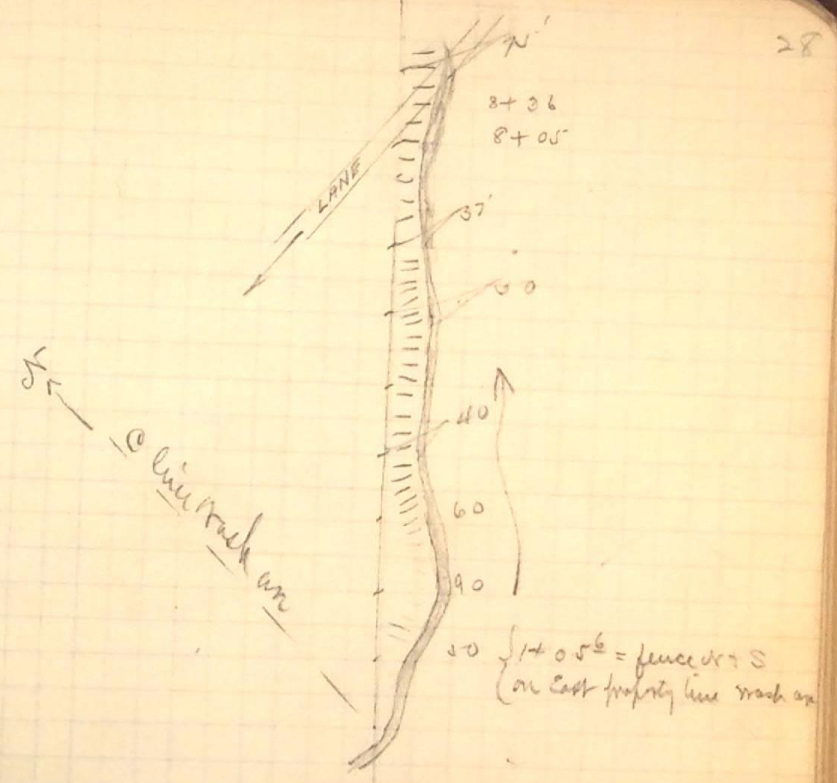

= Center 36⁺ ft (city limits)

